

JDCC

30 October 2023



**GREATER CAMBRIDGE**  
SHARED PLANNING

# 22/02528/OUT – Darwin Green Phases Two and Three Development Site, Cambridge Road, Impington

Page 2

Outline planning permission (all matters reserved except for means of access) for up to 1,000 residential dwellings, secondary school, primary school, community facilities, retail uses, open space and landscaped areas, associated engineering, demolition and infrastructure works



# Western Access Junction

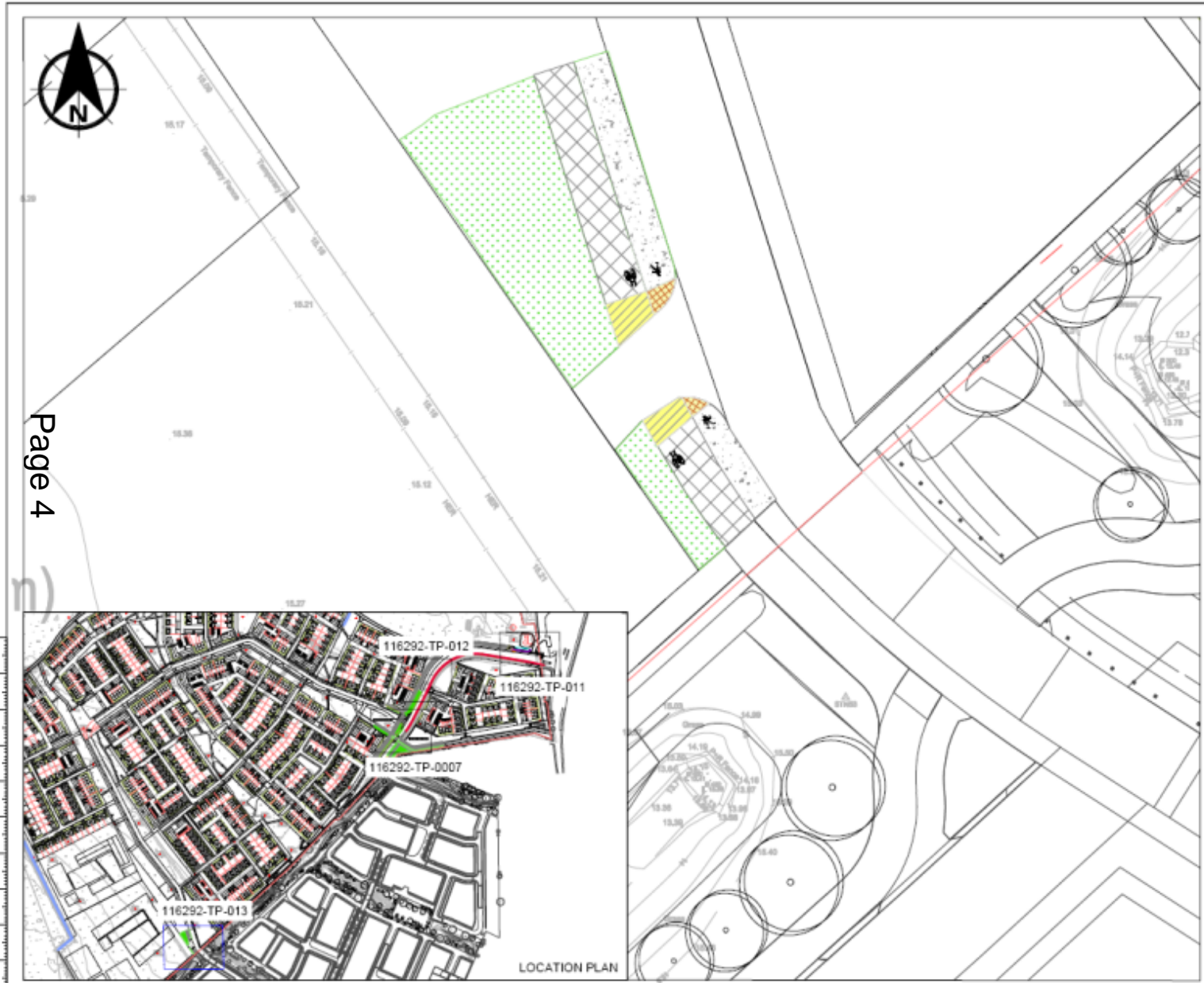

Page 4

## NOTES

- DO NOT SCALE FROM THIS DRAWING MANUALLY OR ELECTRONICALLY.
- THIS DRAWING IS TO BE READ IN CONJUNCTION WITH ALL OTHER RELEVANT PROJECT INFORMATION.
- ALL DATUM LEVELS ARE IN METRES AND DIMENSIONS ARE IN MILLIMETRES UNLESS OTHERWISE STATED.

- PROPOSED PEDIESTRIAN FOOTWAY - SURFACING TO BE SPECIFIED BY CAMBRIDGESHIRE STANDARD DETAILS
- PROPOSED CYCLEWAY - SURFACING TO BE SPECIFIED TO CAMBRIDGESHIRE STANDARD DETAILS
- PROPOSED VERGE
- BLUFF TACTILE SLIPSTAY PAVED - TO BE SPECIFIED TO CAMBRIDGESHIRE STANDARD DETAILS
- CONTOUR TO TRAILLINE TACTILE PAVING - TO BE SPECIFIED TO CAMBRIDGESHIRE STANDARD DETAILS IN ACCORDANCE WITH DTG9 FIGURE 28
- ON-CARRIAGEWAY CYCLE LANE
- TOPOGRAPHICAL LEVEL DATA

PROPOSED DIMING AND LINES TO BE IN ACCORDANCE WITH TSDG0 2/15

REV	DATE	DESCRIPTION	BY	CHKD	APPD
01	15.08.2023	AMENDMENTS TO ADDRESS ODC COMMENTS	AH	LP	LP
02	29.04.2023	FIRST ISSUE	AH	LP	LP

This drawing is a preliminary design and is not to be used for construction. It is subject to change without notice. The client is responsible for ensuring that the design meets all applicable standards and regulations. The design is for information only and does not constitute an offer of any services.

Delaney, Eden House  
2 Drake Street  
London  
EC2M 4LS  
Tel: +44 (0)20 3302 1210  
Web: www.delaney.co.uk



Client:  
**BDW CAMBRIDGESHIRE**

Project Title:  
**DARWIN GREEN PHASES II AND III**

Drawing Title:  
**DG1/DG2 ACCESS JUNCTION (WESTERN ACCESS)**

Rev	Date	Description	By	Check	Appr
03		FOR REVIEW AND COMMENT			
04		FOR INFORMATION			
01		Design LP	LP	LP	LP
02		Issue T200	LP	LP	LP
03		Issue 116292	LP	LP	LP
04		Issue P02	LP	LP	LP

Drawing Number: 116292-TP-00013



# Eastern Access Junction

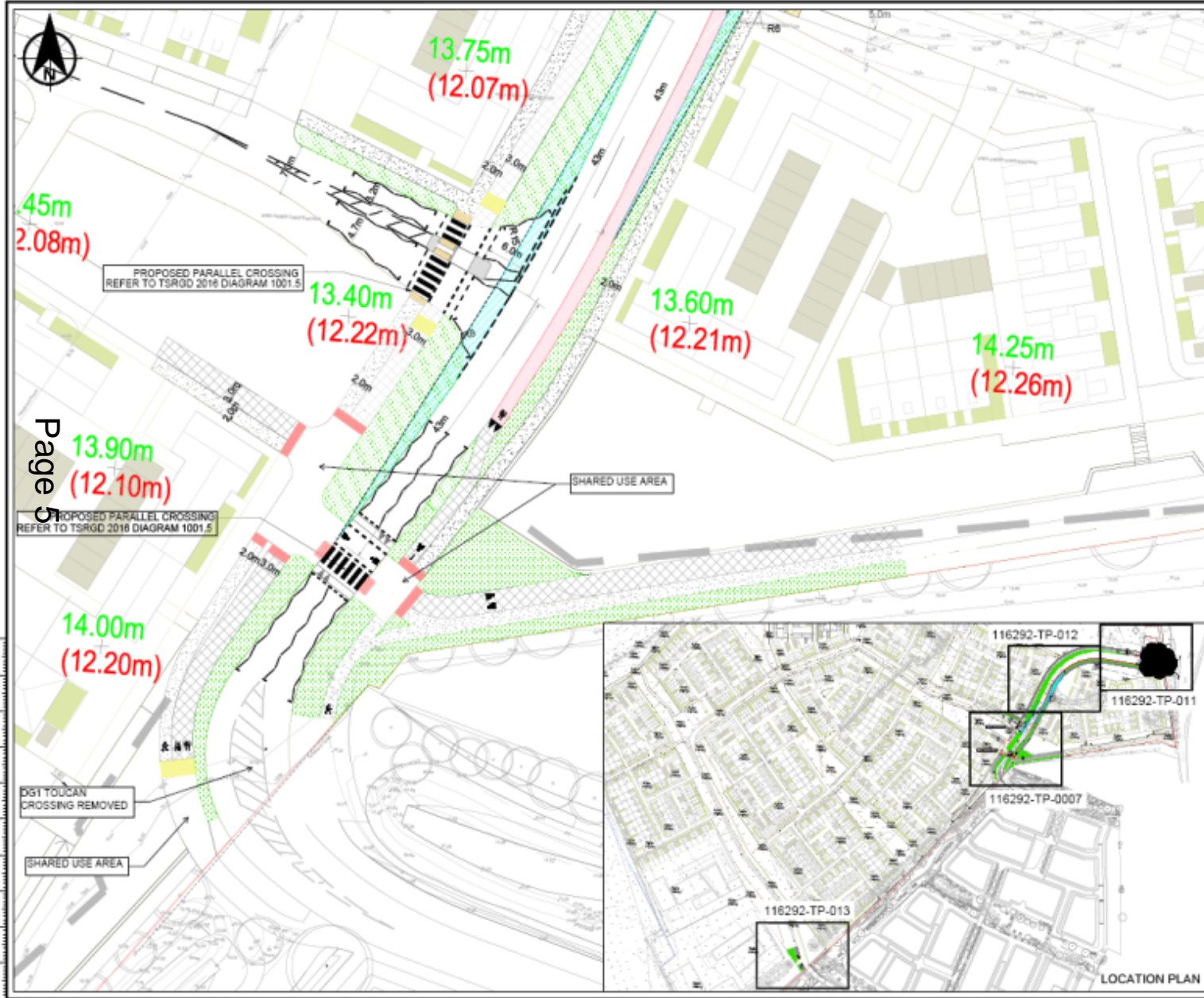

**NOTES**

- DO NOT SCALE FROM THIS DRAWING MANUALLY OR ELECTRONICALLY.
- THIS DRAWING IS TO BE READ IN CONJUNCTION WITH ALL OTHER RELEVANT PROJECT INFORMATION. ALL DATUM LEVELS ARE IN METRES AND DIMENSIONS ARE IN MILLIMETRES UNLESS OTHERWISE STATED.

**LEGEND**

- PROPOSED PEDESTRIAN FOOTWAY - SURFACING TO BE SPECIFIED BY CAMBRIDGESHIRE STANDARD DETAILS
- PROPOSED CYCLEWAY - SURFACING TO BE SPECIFIED TO CAMBRIDGESHIRE STANDARD DETAILS
- PROPOSED VERGE
- MULTI TACTILE BUSTER PAVING - TO BE SPECIFIED TO CAMBRIDGESHIRE STANDARD DETAILS
- CORRIDOR TRAINING TACTILE PAVING - TO BE SPECIFIED TO CAMBRIDGESHIRE STANDARD DETAILS IN ACCORDANCE WITH DTG19 FIGURE 28
- ON-CARRIAGEWAY CYCLE LINE
- ENVELOPE OF VISIBILITY (A58 + 4.5%)
- BITUMEN MATERIAL TO DELINEATE BETWEEN CYCLE / FOOTWAY
- ADD LEVEL DATA
- PROPOSED BOUNDARIES (INDICATE ONLY SUBJECT TO REVIEW AT DETAILED DESIGN STAGE)
- PROPOSED BOUNDARY AND LINES TO BE IN ACCORDANCE WITH TSRGD 2016

Rev	Date	Author	Checked	Drawn	QA'd	App'd
F	10.05.2022	AMENDMENTS TO ADDRESS STAKEHOLDER FEEDBACK	GD	LP	LP	LP
E	09.10.2022	Amendments to London based to address LCC comments	JAH	LP	LP	LP
D	16.06.2022	Amendments to address LCC comments	JAH	LP	LP	LP
C	29.04.2022	LAYOUT UPDATED	JAH	LP	LP	LP
B	11.04.2022	MULTIPLAN LAYOUT UPDATED	JAH	LP	LP	LP
A	18.02.22	REVISED DESIGN ANCHOR ACCESS	KJ	MF	MF	MF

3rd Floor, Eldon House  
2 Eldon Street  
London  
EC1M 6LS  
Tel: +44 (0)20 3802 1210  
Web: www.sweco.co.uk

**SWECO**

**BW CAMBRIDGESHIRE**

FOR REVIEW AND COMMENT

DARWIN GREEN PHASES II AND III

DG1/DG2 ACCESS JUNCTION (EASTERN ACCESS)

Scale	Project	Issue	Drawn	Checked	Approved
1:500	MB	MB	LP	LP	LP
Issue	A3	18/03/20	11/04/22	29/04/22	05/08/22
Project	116292-TP-0007				F

Page 5

# Spine Road Residential Access

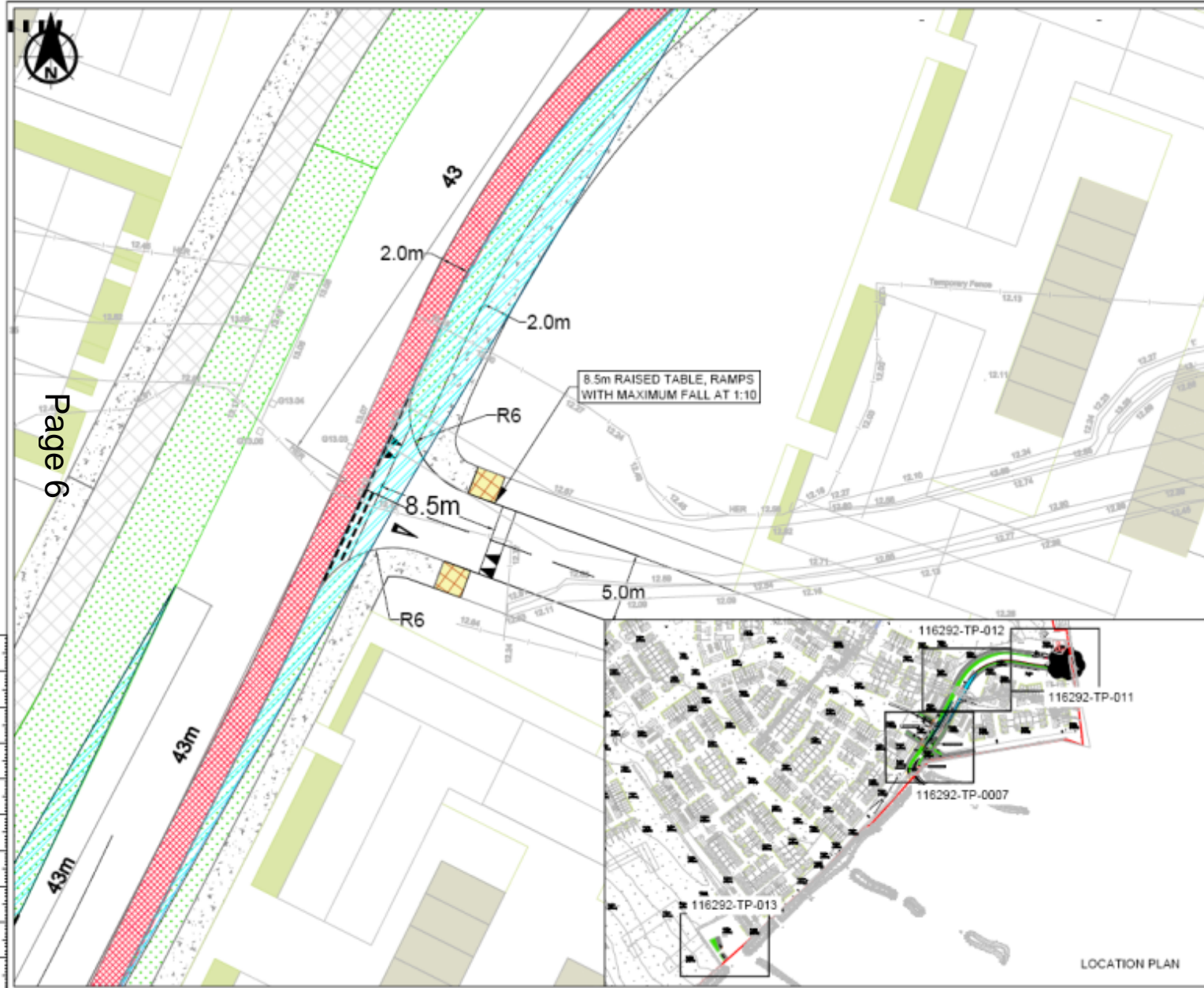

## NOTES

- DO NOT SCALE FROM THIS DRAWING MANUALLY OR ELECTRONICALLY
- THIS DRAWING IS TO BE READ IN CONJUNCTION WITH ALL OTHER RELEVANT PROJECT INFORMATION
- ALL DATUM LEVELS ARE IN METRES AND DIMENSIONS ARE IN METRES UNLESS OTHERWISE STATED

- PROPOSED PEDIESTRIAN FOOTWAY - SURFACING TO BE SPECIFIED BY CAMBRIDGESHIRE STREETS DETAILS
  - PROPOSED CYCLERY - SURFACING TO BE SPECIFIED TO CAMBRIDGESHIRE STANDARD DETAILS
  - ON-CARRIAGEWAY CYCLE LINE
  - PROPOSED VERGE
  - BUFF TACTILE BUSTER PAVING - TO BE SPECIFIED TO CAMBRIDGESHIRE STANDARD DETAILS
  - DEVELOPE OF VISIBILITY 24m x 40m
  - (19.20M) ADD LEVEL DATA
  - (19.20M) PROPOSED LEVELS (INDICATIVE ONLY) SUBJECT TO REVIEW AT DETAILS DESIGN STAGE
- PROPOSED SIGNING AND LIGHTING TO BE IN ACCORDANCE WITH TRGS 2018

PO3	01.03.2022	AMENDMENTS TO RESIDENTIAL ROAD ACCESS	AM	LP	LP
PO3	09.06.2022	AMENDMENTS TO ADDRESS EDC COMMENTS	AM	LP	LP
PO3	11.04.2022	FIRST ISSUE	BC	LP	LP
Rev	Issue	Amendment Details	DC	DP	ADP

1st Floor, 200th Floor  
 2 Essex Street  
 London  
 EC2M 4JD  
 Tel: +44 (0)20 2002 1210  
 Web: www.bentley.co.uk



Client  
**BDW CAMBRIDGESHIRE**

Project Title  
**DARWIN GREEN PHASES II & III**

Drawing Title  
**MASTERPLAN DG1 SPINE ROAD/RESIDENTIAL ACCESS JUNCTION**

Purpose of Issue  
**PRELIMINARY**

Drawn	Checked	Approved	Reviewed
BC	BC	LP	LP

Sheet Size  
**A3**

Scale  
**1:250**

Drawn Ref  
**60206067**

Revision  
**P03**

Drawing Number  
**116292-TP-0012**

Page 6



# Spine Road - Cambridge Road Junction

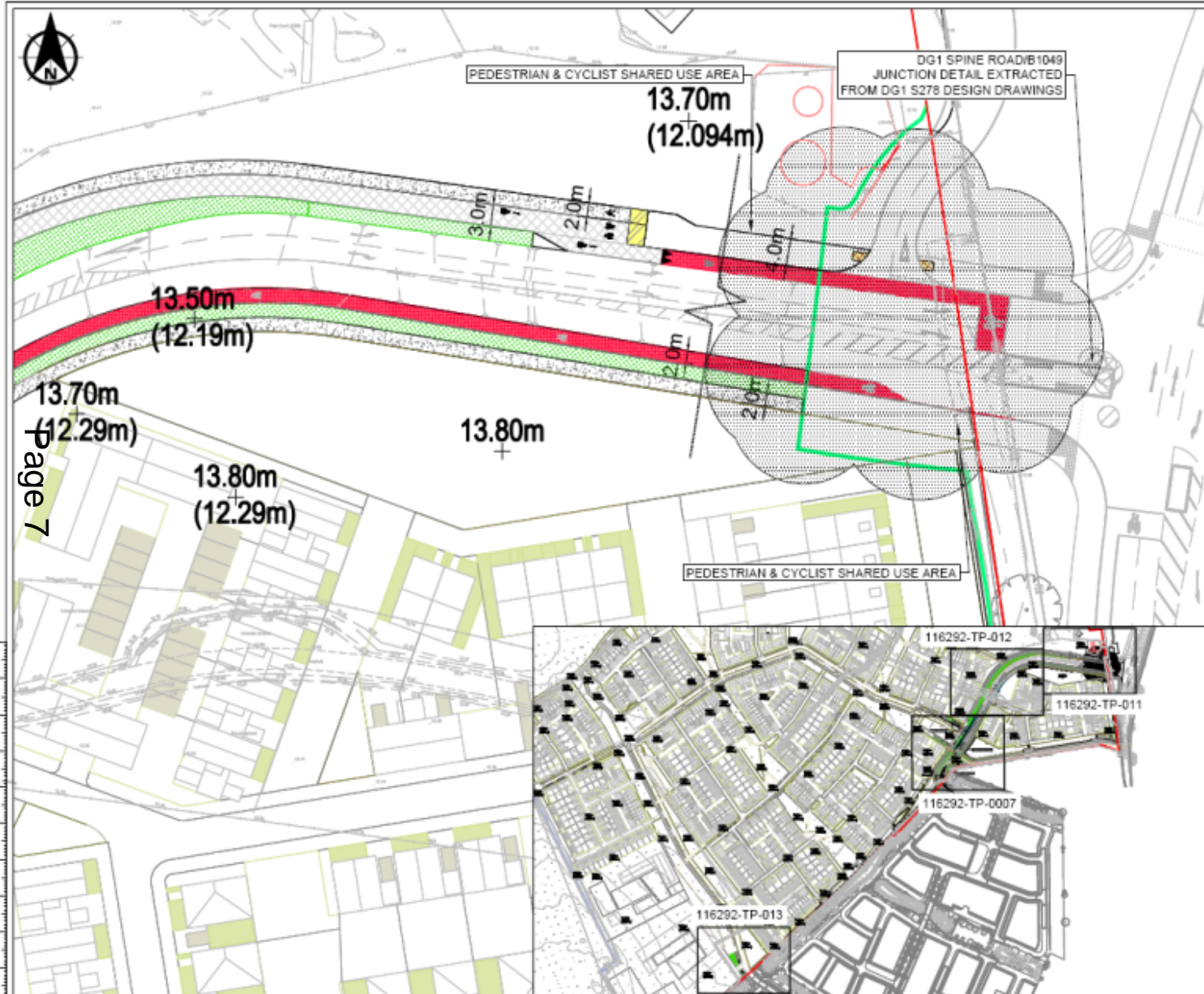

## NOTES

- DO NOT SCALE FROM THIS DRAWING MANUALLY OR ELECTRONICALLY.
- THIS DRAWING IS TO BE READ IN CONJUNCTION WITH ALL OTHER RELEVANT PROJECT INFORMATION.
- ALL DATUM LEVELS ARE IN METRES AND DIMENSIONS ARE IN METRES UNLESS OTHERWISE STATED.

- PROPOSED PEDESTRIAN FOOTWAY - SURFACING TO BE SPECIFIED BY CAMBERDISHIRE STANDARD DETAILS
- PROPOSED CYCLEWAY - SURFACING TO BE SPECIFIED TO CAMBERDISHIRE STANDARD DETAILS
- ON-CARRIAGEWAY CYCLEWAY
- PROPOSED VERGE
- BUFF TACTILE BLISTER PAVING - TO BE SPECIFIED TO CAMBERDISHIRE STANDARD DETAILS
- CONCRETE TACTILE PAVING - TO BE SPECIFIED TO CAMBERDISHIRE STANDARD DETAILS IN ACCORDANCE WITH STRA 2018
- 13.20m AOD LEVEL DATA
- PROPOSED LEVELS (INDICATING ONLY) SUBJECT TO REVIEW AT DETAILED DESIGN STAGE
- D01 S278 APPROVED SCHEME
- PROPOSED SIGNING AND LAMING TO BE IN ACCORDANCE WITH TRASEG 2018

REV	DATE	DESCRIPTION	BY	LP	APP
P03	05.09.2022	AMENDMENTS TO CYCLIST ACCESS TO ON-ROAD CYCLE LANE	AK	LP	LP
P02	06.08.2022	AMENDMENTS TO ADDRESS DCC COMMENTS	AK	LP	LP
P01	11.04.2022	FINAL ISSUE	SK	LP	LP
Rev	Date	Amendment Details	By	LP	App

3rd Floor, Eldon House  
2 Eldon Street  
London  
EC2M 7LS  
Tel: +44 (0)20 3550 1214  
Web: www.bdw.co.uk



Client  
**BDW CAMBRIDGESHIRE**

Project Title  
**DARWIN GREEN PHASES II & III**

Drawing Title  
**MASTERPLAN DG1 SPINE ROAD/SERVICE ACCESS JUNCTION**

Purpose of Issue  
**PRELIMINARY**

Rev	Date	Description
03		FOR REVIEW AND COMMENT

Drawn	Designed	Checked	Approved
SK	SK	LP	LP

Sheet Size A3 Scale 1:500 Sheet Ref 63206067 Project P03  
Drawing Number **116292-TP-0011**

Page 7

# Thorton Close Pedestrian Link

Page 8



- NOTES**
- DO NOT SCALE FROM THIS DRAWING MANUALLY OR ELECTRONICALLY.
  - THIS DRAWING IS TO BE READ IN CONJUNCTION WITH ALL OTHER RELEVANT PROJECT INFORMATION.
  - ALL DATUM LEVELS ARE IN METRES AND DIMENSIONS ARE IN MILLIMETRES UNLESS OTHERWISE STATED.

**KEY**

- PROPOSED SHARED CYCLE/PEDESTRIAN ROUTE - SURFACING TO BE SPECIFIED BY CAMBRIDGESHIRE STANDARD DETAILS
- EXISTING SHARED SURFACE
- EXISTING DITCH
- EXTENT OF ESSENTIAL WORK BOUNDARY
- EXISTING TREE
- TELEGRAPH POLE
- ADE LEVEL DATA

PROPOSED GRADING AND LANS TO BE IN ACCORDANCE WITH TERMS 2/15

LOCATION PLAN

REV	DATE	DESCRIPTION	BY	CHK	APP
002	06.09.2022	TELEGRAPH POLE RELOCATED	AH	LP	LP
001	05.08.2022	FIRST ISSUE	AH	LP	LP

3rd Floor, Eldon House  
2 Eldon Street  
London  
EC2M 6LS  
Tel: +44 (0)20 3000 1200  
Web: www.sweco.co.uk



Client  
**BDW CAMBRIDGESHIRE**

Project Title  
**DARWIN GREEN PHASE II & III**

Drawing Title  
**THORNTON CLOSE CYCLE & PEDESTRIAN LINK**

Revision of Issue  
**PRELIMINARY**

Rev	SS	Drawn	Checked	Approved
01	AH	AH	LP	LP

Scale: 1:250  
Drawing Number: 116292-TP-0014